

Harbor Ridge



Harbor Ridge I



Harbor Ridge II

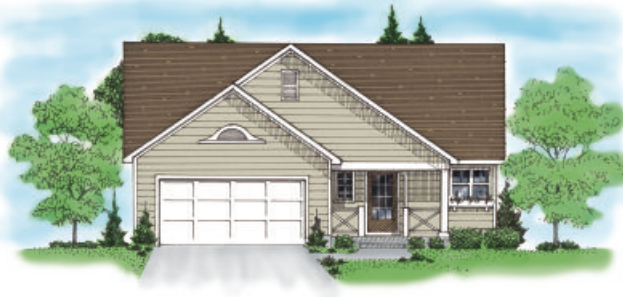

Harbor Ridge III



Main Level

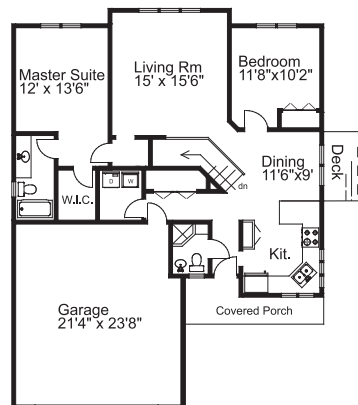

Lower Level

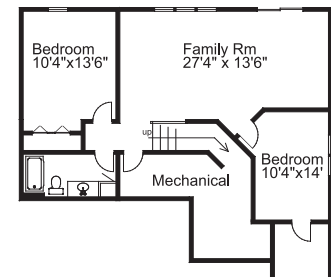

This contemporary ranch style home features a master bedroom with master bath and walk-in closet, second bedroom, full bath and kitchen. Cathedral ceilings open up the dining room. The dining area has sliders to a deck. The lower level is partially framed and can be finished to include a family room, two additional bedrooms and second full bath.

Features

- 1178 Square Feet
- Master Bedroom Suite
- 2-4 Bedrooms
- 2-3 Full Baths
- Living Room
- Cathedral Ceilings
- 10 x 10 Deck
- Optional Family Room
- 2-Stall Garage

Square footage is approximate and elevations and floor plans are conceptual and not intended to be a precise description or to scale.

KBH Homes reserves the right to modify plans, specifications, colors, maps and pricing without notice or obligation. All plans are copyrighted and may not be reproduced without written consent from KBH Homes.

